

THE INFORMATION CONTAINED IN THIS DRAWING IS THE SOLE PROPERTY OF ABBOTT WORKHOLDING PRODUCTS. ANY REPRODUCTION IN PART OR WHOLE WITHOUT THE WRITTEN PERMISSION OF ABBOTT WORKHOLDING PRODUCTS IS PROHIBITED.

ϕ 13/64" Thru
 ϕ 11/32" C'Bore
 2X

ϕ .1255-.1265
 3X
 5/16 Min. To Shoulder
 30°

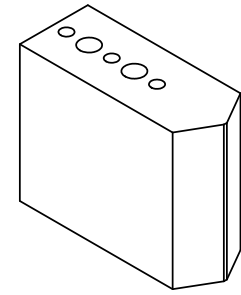

3/4"

1/32"

.500
 .755
 .250
 .5000 TYP.

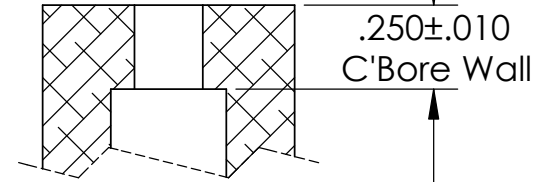
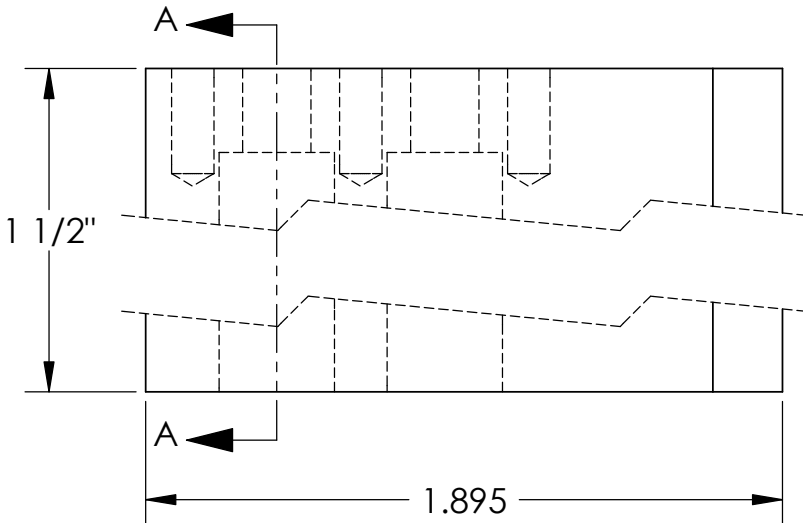

SECTION A-A

UNLESS OTHERWISE SPECIFIED
 DIMENSIONS ARE IN INCHES
 TOLERANCES ARE:
 FRACTIONS DECIMALS ANGLES
 ±1/32 .XX±.015 ±5°
 .XXX±.005
 .XXXX±.0005

Abbott Workholding Products

430 McCall Road
 Manhattan, KS 66502
 785-776-8555
 785-587-0004 Fax
 800-528-6459

www.abbottworkholding.com
 engineering@abbottworkholding.com

| | |
|------------------|-------------------------|
| DRAWN EWP | DATE 06/23/05 |
| MATERIAL 1018 | WEIGHT(POUNDS) 0.5 |
| STYLE R | DISPOSITION Released |

| | | | |
|--------------------|-----------|----------------------|------------|
| CUSTOMER: Stock | SIZE A | Part Name ST141.5 | REV. -- |
|--------------------|-----------|----------------------|------------|